

Product Division Catalog

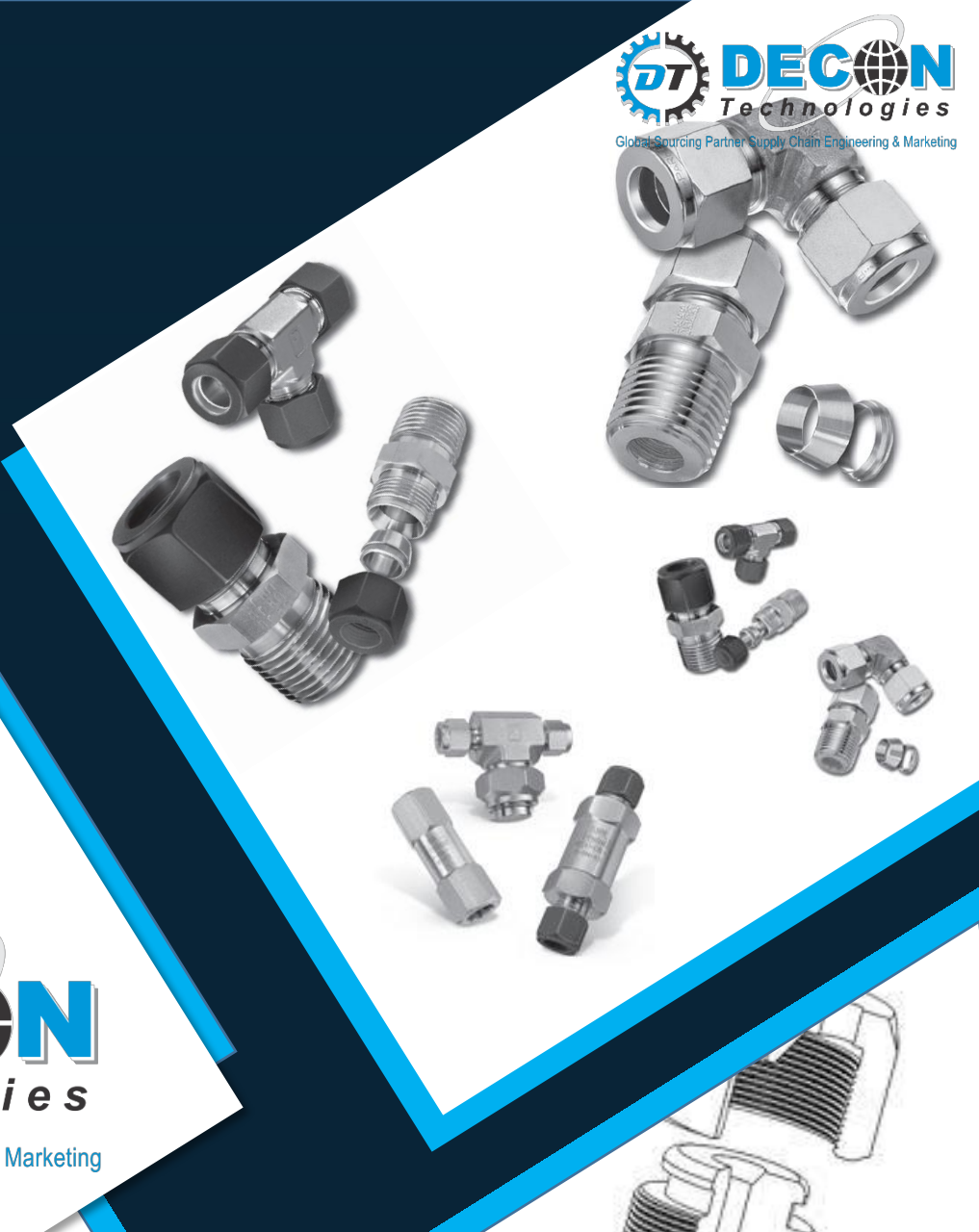

INSTRUMENTATION

❖ *Tube FITTINGS*

❖ *PIPES FITTINGS*

- Elect r omechan ical
- Fil t r at ion
- Fluid & gas handl ing
- Pneumat ics
- Process con t r ol
- aer ospace



Our purpose

DECON Technologies aims to develop strong and long term partnership with clients and vendors by ensuring the highest standard of quality in manufacturing, Engineering and others services.

We endeavour to develop the most efficient producer for our manufacturing processes in order to keep cost low and quality high.



Our Commitment

❖ YOUR TRUSTED SOURCING PARTNER

Support our customers with technology driven, cost-effective, quality compliment, manufacturing solution on time.

DECON Technologies is a trusted manufacturing and engineering services provider with a hard earned reputation for quality services and complete customer satisfaction, strategically located in Central Gujarat, India.

DECON Technologies provide advance functionality, purpose build for your industry. DECON Technologies has proven expertise in supporting efforts to delivered profitable growth in an industries that requires ever increasing level of technical specialization with support from a complex web of supply-chain partner, based on the latest advance from both there consumer and enterprise world.



What We Do...

❖ Manufacturing

- ✓ Investment casting, Sand casting, Pressure die casting, Centrifugal casting (Carbon steel, low Alloy steel, Stainless Steel, Duplex Stainless Steel, Nickel & Cobalt based Alloy, Aluminium Alloy)
- ✓ Forging Components (Non alloy Steel, Alloy Steel, Stainless Steel, High Chrome Steel)
- ✓ High Precision Machined Components.
- ✓ Fabrication Parts
- ✓ Special Plate Components.
- ✓ Rubber & Moulded parts.



❖ Engineering

- ✓ Product development
- ✓ Process Improvement
- ✓ Sub Assembly

❖ Global Sourcing

- ✓ Supply Chain
- ✓ Engineering & Marketing

DECON Technologies is a ISO 9001 2015 certified Global Sourcing Partners located at Vadodara, Gujarat in association with world class Investment and Sand casting Foundry.

We have two state of the art in house manufacturing facility utilizing precision machinery and equipment for production and inspection.

We supply Variety of high precision critical components for various sector like Oil & Gas, Power, Chemical & Process Industry which are custom-made to exact specification and expectations of our Customers.

Product

• fittings

Page/

➤ TUBE FITTINGS..... 05

➤ PIPE FITTINGS..... 17



• manifold

Page/

◀ 2/3/5 VALVE
MANIFOLD 00

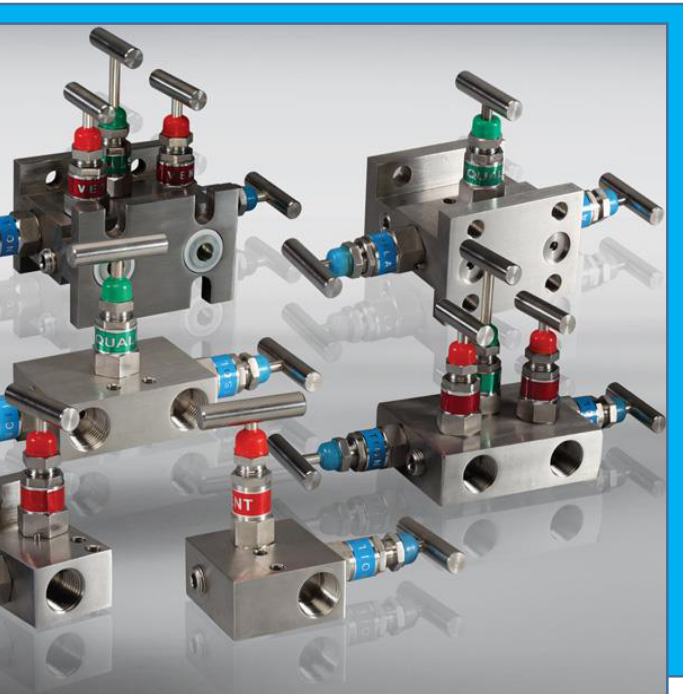

• valves

Page/

➤ NEEDLE VALVE..... 00



• Industrial need

We're guided by a relentless drive to help our customers become more productive and achieve higher levels of profitability by engineering the best systems for their requirements. It means looking at customer applications from many angles to find new ways to create value. Whatever the motion and control technology need.

INDUSTRIES WE SERVE

- Electromechanical
- Filtration
- Fluid & gas handling
- Pneumatics
- Process control
- Aerospace



Fit t i n g s



▶ TUBE FITTINGS

INDEX

	<ul style="list-style-type: none">• Male Connector• Page 06		<ul style="list-style-type: none">• Female Elbow• Page 09
	<ul style="list-style-type: none">• Female Connector• Page 07		<ul style="list-style-type: none">• Equal Union / Unequal Union• Page..... 10
	<ul style="list-style-type: none">• Male Elbow• Page 08		
	<ul style="list-style-type: none">• Union Elbow / Cross• Page..... 11		<ul style="list-style-type: none">• Bulkhead Male / Female connector• Page 14
	<ul style="list-style-type: none">• Bulkhead Union / Union Tee• Page..... 12		<ul style="list-style-type: none">• Male Branch Tee / Male Run Tee• Page 15
	<ul style="list-style-type: none">• Cap / Plugs• Page..... 13		<ul style="list-style-type: none">• Ferrules / Nuts• Page 16

Tube fittings

• Male Connector

Metric Range		Dimensions are in mm					
Part No.	T OD	P	N	L	H BODY L	G NACK	F BODY
6mMC2	6	1/8"	10	33.5	26.0	14	14
6mMC4	6	1/4"	14	38.4	30.2	14	14
6mMC6	6	3/8"	14	39.1	31.0	14	17.2
6mMC8	6	1/2"	19	44.5	36.5	14	22
8mMC2	8	1/8"	10	34.5	26.6	16	14
8mMC4	8	1/4"	14	39.3	31.4	16	14
10mMC2	10	1/8"	10	35.8	27.8	19	17
10mMC4	10	1/4"	14	40.5	32.5	19	17
10mMC6	10	3/8"	14	40.5	32.5	19	19
10mMC8	10	1/2"	19	46.0	38.1	19	22
10mMC12	10	3/4"	19	46.8	39.0	19	27
12mMC4	12	1/4"	14	43.7	33.4	22	22
12mMC6	12	3/8"	14.2	43.7	33.4	22	22
12mMC8	12	1/2"	19	48.5	38.1	22	22
12mMC12	12	3/4"	19	49.2	39.0	22	27
16mMC6	16	3/8"	14	44.5	34.2	27	24
16mMC8	16	1/2"	19	49.2	39.0	27	24
16mMC12	16	3/4"	19	49.2	39.0	27	27
18mMC8	18	1/2"	19	50.8	40.5	30	27
18mMC12	18	3/4"	19	50.8	40.5	30	27
20mMC8	20	1/2"	19	50.8	40.5	30	27
20mMC12	20	3/4"	19	50.8	40.5	30	27
20mMC16	20	1"	24	56.4	46.0	30	36
25mMC12	25	3/4"	19	57.2	45.3	38	36
25mMC16	25	1"	24	62.0	50.0	38	36

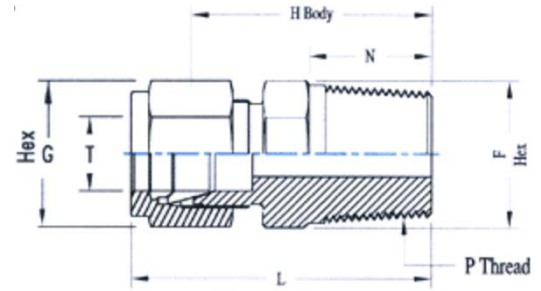

Available with **NPT** or **BSPT** threads.



Imperial Range		Dimensions are in inches					
Part No.	T OD	P	N	L	H BODY L	G NACK	F BODY
2MC2	1/8	1/8	0.38	1.19	0.91	7/16	1/2
2MC4	1/8	1/4	0.56	1.41	1.13	7/16	9/16
4MC2	1/4	1/8	0.38	1.29	1.00	9/16	1/2
4MC4	1/4	1/4	0.56	1.50	1.19	9/16	9/16
4MC6	1/4	3/8	0.56	1.51	1.19	9/16	11/16
4MC8	1/4	1/2	0.75	1.73	1.44	9/16	7/8
5MC2	5/16	1/8	0.38	1.34	1.05	5/8	9/16
5MC4	5/16	1/4	0.56	1.52	1.23	5/8	9/16
6MC2	3/8	1/8	0.38	1.38	1.09	11/16	5/8
6MC4	3/8	1/4	0.56	1.57	1.28	11/16	5/8
6MC6	3/8	3/8	0.56	1.57	1.28	11/16	11/16
6MC8	3/8	1/2	0.75	1.79	1.50	11/16	7/8
6MC12	3/8	3/4	0.75	1.82	1.53	11/16	11/16
8MC4	1/2	1/4	0.56	1.71	1.31	7/8	7/8
8MC6	1/2	3/8	0.56	1.71	1.31	7/8	7/8
8MC8	1/2	1/2	0.75	1.90	1.50	7/8	7/8
8MC12	1/2	3/4	0.75	1.93	1.53	7/8	11/16
10MC6	5/8	3/8	0.56	1.74	1.34	1.0	15/16
10MC8	5/8	1/2	0.75	1.93	1.53	1.0	15/16
10MC12	5/8	3/4	0.75	1.93	1.53	1.0	11/16
12MC8	3/4	1/2	0.75	1.99	1.59	1.18	11/16
12MC12	3/4	3/4	0.75	1.99	1.59	1.18	11/16
12MC16	3/4	1	0.94	2.21	1.81	1.18	1 3/8
16MC12	1	3/4	0.75	2.26	1.78	1 1/2	1 3/8
16MC16	1	1	0.94	2.45	1.97	1 1/2	1 3/8

Female Connector

Metric Range		Dimensions are in mm					
Part No.	T OD	P	N	L	H BODY L	G NACK	F BODY
6mFC2	6	1/8"	10	31.75	23.80	14	14
6mFC4	6	1/4"	14	36.50	28.60	14	19
6mFC6	6	3/8"	14	38.00	30.20	14	22
6mFC8	6	1/2"	19	43.70	35.70	14	27
8mFC2	8	1/8"	10	32.54	24.60	16	14
8mFC4	8	1/4"	14	37.30	29.40	16	19
10mFC2	10	1/8"	10	33.40	25.40	19	17
10mFC4	10	1/4"	14	38.10	30.20	19	19
10mFC6	10	3/8"	14	39.70	31.80	19	22
10mFC8	10	1/2"	19	44.50	36.50	19	27
10mFC12	10	3/4"	19	45.00	37.00	19	32
12mFC4	12	1/4"	14	42.10	31.80	22	22
12mFC6	12	3/8"	14.2	42.10	31.80	22	22
12mFC8	12	1/2"	19	46.80	36.50	22	27
12mFC12	12	3/4"	19	47.30	37.00	22	32
16mFC6	16	3/8"	14	42.00	31.80	27	24
16mFC8	16	1/2"	19	46.80	36.50	27	27
16mFC12	16	3/4"	19	47.30	37.00	27	32
18mFC8	18	1/2"	19	46.80	36.50	30	27
18mFC12	18	3/4"	19	48.40	38.10	30	32
20mFC8	20	1/2"	19	46.80	36.50	30	27
20mFC12	20	3/4"	19	48.40	38.10	30	32
20mFC16	20	1"	24	53.00	43.00	30	41
25mFC12	25	3/4"	19	53.20	41.30	38	36
25mFC16	25	1"	24	62.00	50.10	38	41

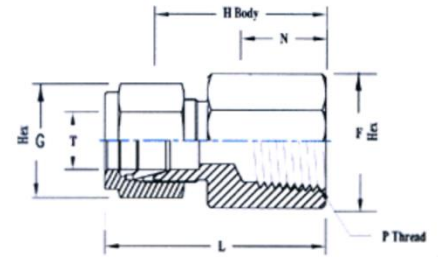

Available with **NPT** or **BSPT** threads.



Imperial Range		Dimensions are in inches					
Part No.	T OD	P	N	L	H BODY L	G NACK	F BODY
2FC2	1/8	1/8	0.38	1.16	0.88	7/16	9/16
2FC4	1/8	1/4	0.56	1.34	1.06	7/16	3/4
4FC2	1/4	1/8	0.38	1.23	0.94	9/16	9/16
4FC4	1/4	1/4	0.56	1.41	1.12	9/16	3/4
4FC6	1/4	3/8	0.56	1.48	1.19	9/16	7/8
4FC8	1/4	1/2	0.75	1.73	1.41	9/16	1 1/16
5FC2	5/16	1/8	0.38	1.26	0.97	5/8	9/16
5FC4	5/16	1/4	0.56	1.45	1.16	5/8	3/4
6FC2	3/8	1/8	0.38	1.29	1.00	11/16	5/8
6FC4	3/8	1/4	0.56	1.48	1.20	11/16	3/4
6FC6	3/8	3/8	0.56	1.54	1.25	11/16	7/8
6FC8	3/8	1/2	0.75	1.73	1.44	11/16	11/16
6FC12	3/8	3/4	0.75	1.80	1.47	11/16	1 1/8
8FC4	1/2	1/4	0.56	1.65	1.25	7/8	7/8
8FC6	1/2	3/8	0.56	1.65	1.25	7/8	7/8
8FC8	1/2	1/2	0.75	1.84	1.44	7/8	1 1/16
8FC12	1/2	3/4	0.75	1.88	1.47	7/8	1 1/8
10FC6	5/8	3/8	0.56	1.65	1.25	1.0	15/16
10FC8	5/8	1/2	0.75	1.84	1.44	1.0	1 1/16
10FC12	5/8	3/4	0.75	1.87	1.47	1.0	1 1/8
12FC8	3/4	1/2	0.75	1.84	1.44	1.18	1 1/16
12FC12	3/4	3/4	0.75	1.90	1.50	1.18	1 1/8
12FC16	3/4	1	0.94	2.10	1.70	1.18	1 5/8
16FC12	1	3/4	0.75	2.10	1.62	1 1/2	1 3/8
16FC16	1	1	0.94	2.45	1.97	1 1/2	1 5/8

• Male Elbow

Metric Range		Dimensions are in mm					
Part No.	T OD	P	N	L	H BODY L	G NACK	F BODY
6mME2	6	1/8"	10	19.85	19.60	14	15
6mME4	6	1/4"	14	23.80	19.80	14	15
6mME6	6	3/8"	14	23.60	21.40	14	17.2
6mME8	6	1/2"	19	33.40	23.10	14	22
8mME2	8	1/8"	10	20.70	22.30	16	15
8mME4	8	1/4"	14	25.40	22.30	16	15
10mME2	10	1/8"	10	22.30	23.10	19	17
10mME4	10	1/4"	14	25.40	23.10	19	17
10mME6	10	3/8"	14	28.60	23.10	19	19
10mME8	10	1/2"	19	31.80	25.00	19	22
10mME12	10	3/4"	19	32.80	28.00	19	27
12mME4	12	1/4"	14	28.60	25.00	22	22
12mME6	12	3/8"	14.2	28.60	25.00	22	22
12mME8	12	1/2"	19	33.40	25.00	22	22
12mME12	12	3/4"	19	34.40	28.00	22	27
16mME6	16	3/8"	14	31.80	26.20	27	24
16mME8	16	1/2"	19	35.00	26.20	27	24
16mME12	16	3/4"	19	36.00	29.20	27	27
18mME8	18	1/2"	19	38.10	29.40	30	27
18mME12	18	3/4"	19	38.10	28.40	30	27
20mME8	20	1/2"	19	38.10	29.30	30	27
20mME12	20	3/4"	19	38.10	29.40	30	27
20mME16	20	1"	24	40.00	33.40	30	36
25mME12	25	3/4"	19	38.10	33.40	38	36
25mME16	25	1"	24	46.90	33.40	38	36

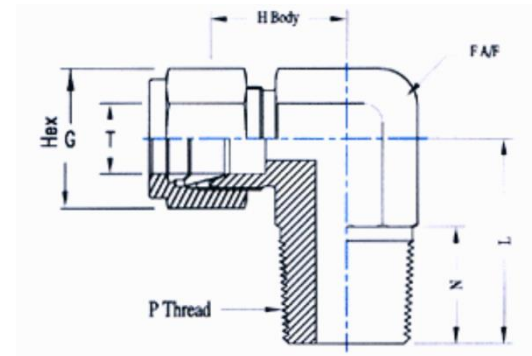

Available with *NPT* or *BSPT* threads.



Imperial Range		Dimensions are in inches					
Part No.	T OD	P	N	L	H BODY L	G NACK	F BODY
2ME2	1/8	1/8	0.38	0.76	0.72	7/16	1/2
2ME4	1/8	1/4	0.56	0.94	0.72	7/16	0.60
4ME2	1/4	1/8	0.38	0.76	0.78	9/16	0.60
4ME4	1/4	1/4	0.56	0.94	0.78	9/16	0.60
4ME6	1/4	3/8	0.56	1.00	0.84	9/16	11/16
4ME8	1/4	1/2	0.75	1.26	0.91	9/16	7/8
5ME2	5/16	1/8	0.38	0.82	0.88	5/8	0.60
5ME4	5/16	1/4	0.56	1.00	0.88	5/8	0.60
6ME2	3/8	1/8	0.38	0.82	0.91	11/16	5/8
6ME4	3/8	1/4	0.56	1.00	0.91	11/16	5/8
6ME6	3/8	3/8	0.56	1.00	0.91	11/16	11/16
6ME8	3/8	1/2	0.75	1.26	0.98	11/16	7/8
6ME12	3/8	3/4	0.75	1.30	1.10	11/16	11/16
8ME4	1/2	1/4	0.56	1.08	0.98	7/8	7/8
8ME6	1/2	3/8	0.56	1.08	0.98	7/8	7/8
8ME8	1/2	1/2	0.75	1.26	0.98	7/8	7/8
8ME12	1/2	3/4	0.75	1.30	1.10	7/8	11/16
10ME6	5/8	3/8	0.56	1.16	1.06	1.0	15/16
10ME8	5/8	1/2	0.75	1.36	1.06	1.0	15/16
10ME12	5/8	3/4	0.75	1.40	1.20	1.0	11/16
12ME8	3/4	1/2	0.75	1.39	1.11	1.18	11/16
12ME12	3/4	3/4	0.75	1.39	1.11	1.18	11/16
12ME16	3/4	1	0.94	1.60	1.31	1.18	1 3/8
16ME12	1	3/4	0.75	1.66	1.31	1 1/2	1 3/8
16ME16	1	1	0.94	1.84	1.31	1 1/2	1 3/8

Female Elbow

Metric Range		Dimensions are in mm					
Part No.	T OD	P	N	L	H BODY L	G NACK	F BODY
6mFE2	6	1/8"	10	19.1	19.1	14	15
6mFE4	6	1/4"	14	21.4	22.2	14	19
6mFE6	6	3/8"	14	21.4	25.4	14	22
6mFE8	6	1/2"	19	26.1	28.7	14	27
8mFE2	8	1/8"	10	21.0	21.0	16	15
8mFE4	8	1/4"	14	22.2	23.1	16	19
10mFE2	10	1/8"	10	22.3	22.3	19	17
10mFE4	10	1/4"	14	23.0	23.0	19	19
10mFE6	10	3/8"	14	21.4	26.0	19	22
10mFE8	10	1/2"	19	26.1	29.5	19	27
10mFE12	10	3/4"	19	29.5	33.0	19	32
12mFE4	12	1/4"	14	23.0	24.6	22	22
12mFE6	12	3/8"	14.2	23.0	26.0	22	22
12mFE8	12	1/2"	19	28.5	28.5	22	27
12mFE12	12	3/4"	19	31.5	31.5	22	32
16mFE6	16	3/8"	14	24.5	24.5	27	24
16mFE8	16	1/2"	19	28.5	28.5	27	27
16mFE12	16	3/4"	19	31.5	31.5	27	32
18mFE8	18	1/2"	19	29.4	29.4	30	27
18mFE12	18	3/4"	19	32.5	32.5	30	32
20mFE8	20	1/2"	19	29.7	30.0	30	27
20mFE12	20	3/4"	19	31.7	32.5	30	32
20mFE16	20	1"	24	35.0	35.0	30	36
25mFE12	25	3/4"	19	31.7	33.4	38	36
25mFE16	25	1"	24	38.1	38.1	38	36

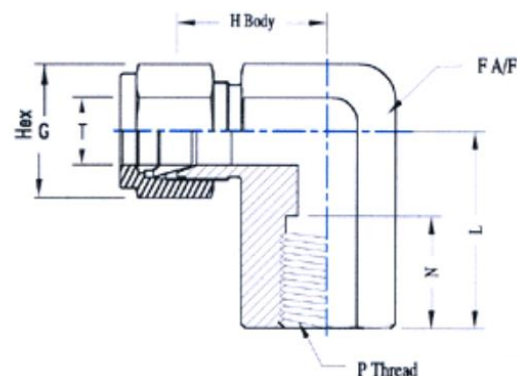

Available with *NPT* or *BSPT* threads.



Imperial Range		Dimensions are in inches					
Part No.	T OD	P	N	L	H BODY L	G NACK	F BODY
2FE2	1/8	1/8	0.38	0.76	0.69	7/16	0.5
2FE4	1/8	1/4	0.56	0.88	0.81	7/16	0.69
4FE2	1/4	1/8	0.38	0.76	0.75	9/16	0.75
4FE4	1/4	1/4	0.56	0.88	0.88	9/16	0.88
4FE6	1/4	3/8	0.56	0.93	0.93	9/16	7/8
4FE8	1/4	1/2	0.75	1.02	1.02	9/16	1.12
5FE2	5/16	1/8	0.38	0.75	0.88	5/8	0.88
5FE4	5/16	1/4	0.56	0.88	0.91	5/8	0.91
6FE2	3/8	1/8	0.38	0.75	0.91	11/16	0.63
6FE4	3/8	1/4	0.56	0.88	0.94	11/16	0.69
6FE6	3/8	3/8	0.56	0.88	1.03	11/16	0.81
6FE8	3/8	1/2	0.75	1.12	1.12	11/16	1.12
6FE12	3/8	3/4	0.75	1.25	1.25	11/16	1.25
8FE4	1/2	1/4	0.56	0.88	0.98	7/8	7/8
8FE6	1/2	3/8	0.56	0.88	1.03	7/8	7/8
8FE8	1/2	1/2	0.75	1.12	1.12	7/8	1.12
8FE12	1/2	3/4	0.75	1.25	1.25	7/8	1.25
10FE6	5/8	3/8	0.56	0.88	1.06	1.0	15/16
10FE8	5/8	1/2	0.75	1.12	1.12	1.0	1.12
10FE12	5/8	3/4	0.75	1.32	1.32	1.0	1.25
12FE8	3/4	1/2	0.75	0.75	1.11	30	1 1/16
12FE12	3/4	3/4	0.75	0.75	1.25	30	1.25
12FE16	3/4	1	0.94	0.94	1.50	30	1.62
16FE12	1	3/4	0.75	0.75	1.31	1 1/2	1.41
16FE16	1	1	0.94	0.75	1.50	1 1/2	1.62

• Equal Union

Metric Range		Dimensions are in mm			
Part No.	T OD	L	H BODY L	G NUT	F BODY
6mU	6	42.10	26.2	14	14
8mU	8	44.05	28.2	16	14
10mU	10	46.05	30.2	19	17
12mU	12	51.60	31.0	22	22
16mU	16	52.40	31.2	27	24
18mU	18	54.00	33.4	30	27
20mU	20	54.00	33.4	30	27
25mU	25	64.30	40.5	38	36

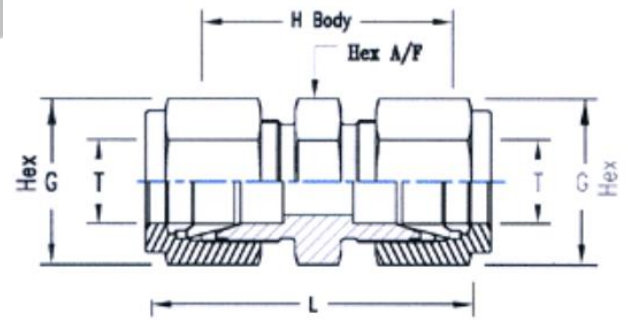

Imperial Range		Dimensions are in inches			
Part No.	T OD	L	H BODY L	G NUT	F BODY
2U	1/8	1.44	0.88	7/16	1/2
4U	1/4	1.61	1.03	9/16	1/2
5U	5/16	1.68	1.10	5/8	9/16
6U	3/8	1.77	1.19	1 1/16	5/8
8U	1/2	2.02	1.22	7/8	7/8
10U	5/8	2.05	1.25	1.0	15/16
12U	3/4	2.11	1.31	1 1/8	1 1/16
16U	1	2.55	1.59	1 1/2	1 3/8

• Unequal Union

Metric Range		Dimensions are in mm					
Part No.	T OD	T1 OD	L	H BODY L	G NUT	G1 NUT	F BODY
8-6mRU	8	6	43.2	27.4	16	14	14
10-6mRU	10	6	44.5	28.6	19	14	17
10-8mRU	10	8	45.2	29.4	19	16	17
12-6mRU	12	6	47.6	29.4	22	14	22
12-10mRU	12	10	49.2	31.0	22	19	22
16-12mRU	16	12	52.4	31.8	27	22	24
20-12mRU	20	12	54.0	33.4	30	22	27
25-20mRU	25	20	60.4	38.1	38	30	36

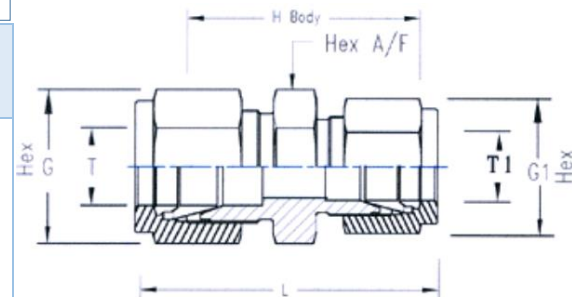

Imperial Range		Dimensions are in inches					
Part No.	T OD	T1 OD	L	H BODY L	G NUT	G1 NUT	F BODY
4RU2	1/4	1/8	1.56	0.97	9/16	7/16	1/2
6RU4	3/8	1/4	1.70	1.12	11/16	9/16	5/8
8RU4	1/2	1/4	1.85	1.16	7/8	9/16	7/8
8RU6	1/2	3/8	1.91	1.22	7/8	11/16	7/8
10RU6	5/8	3/8	1.94	1.25	1.0	7/8	15/16
12RU8	3/4	1/2	2.11	1.31	1 1/8	1.0	1 1/16
12RU10	3/4	5/8	2.11	1.31	1 1/8	1 1/8	1 1/16
16RU12	1	3/4	2.47	1.59	1 1/2	1 1/2	1 3/8

• Union Elbow

Metric Range		Dimensions are in mm			
Part No.	T OD	L	H BODY L	G NUT	F BODY
6mELU	6	26.2	19.8	14	15
8mELU	8	28.6	22.3	16	15
10mELU	10	29.4	23.11	19	17
12mELU	12	35.0	25.05	22	22
20mELU	20	39.7	29.4	30	27
25mELU	25	45.3	33.4	38	36

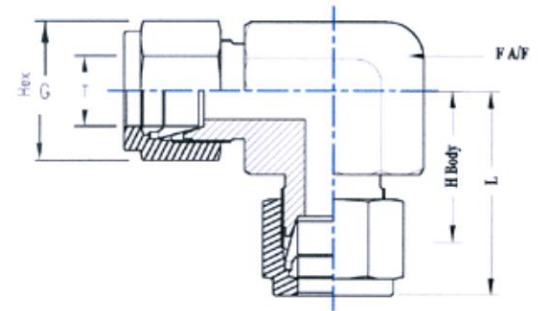

Imperial Range		Dimensions are in inches			
Part No.	T OD	L	H BODY L	G NUT	F BODY
6 ELU	1/4	1.07	0.78	9/16	0.6
8 ELU	3/8	1.20	0.91	11/16	0.6
10 ELU	1/2	1.38	1.01	7/8	7/8
12 ELU	5/8	1.46	1.06	1.01	0.94
20 ELU	3/4	1.51	1.11	1 1/8	1.06
25 ELU	1	1.79	1.31	1 1/2	1 3/8

• Equal Union Cross

Metric Range		Dimensions are in mm			
Part No.	T OD	L	H BODY L	G NUT	F BODY
6m CR	6	54.4	39.6	14	15
8m CR	8	59.4	44.4	16	15
10m CR	10	61.6	46.2	19	17
12m CR	12	70.0	51.0	22	22
20m CR	20	78.8	58.8	30	27
25m CR	25	90.5	67.1	38	36

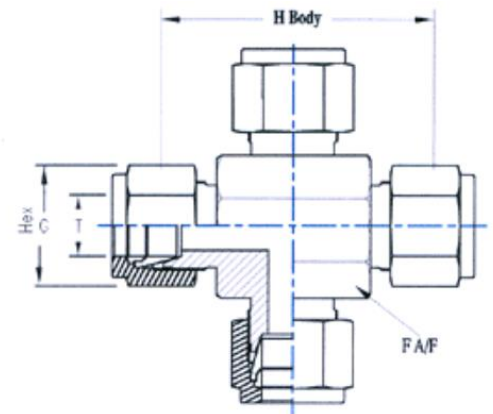

Imperial Range		Dimensions are in inches			
Part No.	T OD	L	H BODY L	G NUT	F BODY
4 CR	1/4	2.25	1.56	9/16	0.6
6 CR	3/8	2.40	1.82	11/16	0.6
8 CR	1/2	2.76	1.96	7/8	7/8
10 CR	5/8	2.92	2.12	1	15/16
12 CR	3/4	3.02	2.22	1 1/8	1.06
16 CR	1	3.58	2.62	1 1/2	1 3/8

Tube fittings

• Bulkhead Union

Metric Range		Dimensions are in mm			
Part No.	T OD	L	H BODY L	G NUT	F BODY
6m BHU	6	58.8	42.9	14	16
8m BHU	8	61.9	46.1	16	19
10m BHU	10	63.5	47.7	19	22
12m BHU	12	71.5	50.1	22	24
20m BHU	20	79.4	58.7	30	30
25m BHU	25	95.3	71.5	38	41

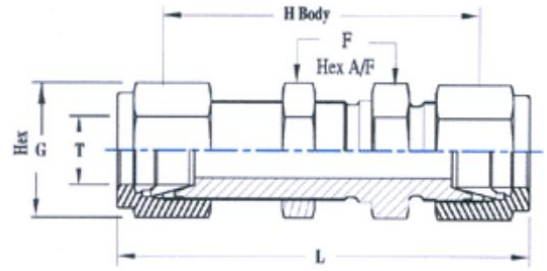

Imperial Range		Dimensions are in inches			
Part No.	T OD	L	H BODY L	G NUT	F BODY
4 BHU	1/4	2.27	1.69	9/16	5/8
6 BHU	3/8	2.46	1.88	11/16	3/4
8 BHU	1/2	2.80	2.00	7/8	15/16
10 BHU	5/8	2.81	2.06	1.01	1.01
12 BHU	3/4	3.11	2.31	1 1/8	1 3/16
16 BHU	1	3.75	2.81	1 1/2	1 5/8

• Bulkhead Union Tee

Metric Range		Dimensions are in mm			
Part No.	T OD	L	H BODY L	G NUT	F BODY
6mTTT	6	54.4	39.63	14	15
8mTTT	8	59.4	44.4	16	15
10mTTT	10	61.6	46.2	19	17
12mTTT	12	70.0	51.0	22	22
20mTTT	20	78.8	58.8	30	27
25mTTT	25	90.5	67.1	38	36

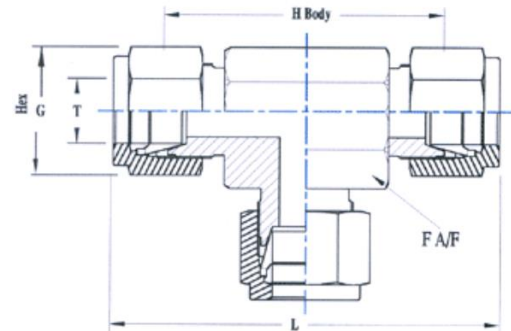

Imperial Range		Dimensions are in inches			
Part No.	T OD	L	H BODY L	G NUT	F BODY
4TTT	1/4	2.25	1.56	9/16	0.6
6TTT	3/8	2.40	1.82	11/16	0.6
8TTT	1/2	2.76	1.96	7/8	7/8
10TTT	5/8	2.92	2.12	1.01	15/16
12TTT	3/4	3.02	2.22	1 1/8	1.06
16TTT	1	3.58	2.62	1 1/2	1 3/8

• Cap – (Tube end Closer)

Metric Range		Dimensions are in mm			
Part No.	T OD	L	H BODY L	G NUT	F BODY
6m CAP	6	23.81	16.0	14	14
8m CAP	8	25.00	17.7	16	14
10m CAP	10	26.20	18.3	19	17
12m CAP	12	29.40	19.1	22	22
16m CAP	16	30.20	19.9	27	24
18m CAP	18	31.80	21.5	30	27
20m CAP	20	31.80	21.5	30	27
25m CAP	25	38.10	26.2	38	36

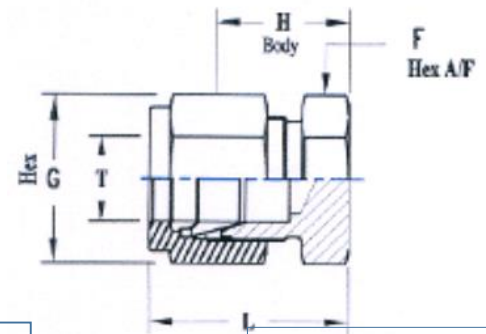

Imperial Range		Dimensions are in inches			
Part No.	T OD	L	H BODY L	G NUT	F BODY
2 CAP	1/8	0.81	0.53	7/16	1/2
4 CAP	1/4	0.91	0.62	9/16	1/2
5 CAP	5/16	0.96	0.67	5/8	9/16
6 CAP	3/8	1.01	0.72	11/16	5/8
8 CAP	1/2	1.15	0.75	7/8	7/8
10 CAP	5/8	1.18	0.78	1	15/16
12 CAP	3/4	1.24	0.84	1 1/8	1 1/16
16 CAP	1	1.51	1.03	1 1/2	1 3/8

• Plug – (Fitting end Closer)

Metric Range		Dimensions are in mm	
Part No.	T OD	G NUT	
6m PLUG	6	14	
8m PLUG	8	16	
10m PLUG	10	19	
12m PLUG	12	22	
16m PLUG	16	27	
18m PLUG	18	30	
20m PLUG	20	30	
25m PLUG	25	38	

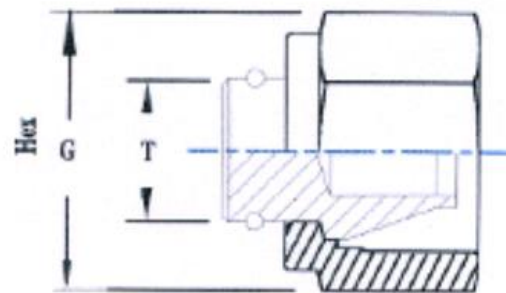

Imperial Range		Dimensions are in inches	
Part No.	T OD	G NUT	
6 PLUG	1/8	7/16	
8 PLUG	1/4	9/16	
10 PLUG	5/16	5/8	
12 PLUG	3/8	11/16	
16 PLUG	1/2	7/8	
18 PLUG	5/8	1	
20 PLUG	3/4	1 1/8	
25 PLUG	1	1 1/2	

• Bulkhead Male Connector

Metric Range		Dimensions are in mm			
Part No.	T OD	L	H BODY L	G NUT	F BODY
6m BHU	6	58.8	42.9	14	16
8m BHU	8	61.9	46.1	16	19
10m BHU	10	63.5	47.7	19	22
12m BHU	12	71.5	50.1	22	24
20m BHU	20	79.4	58.7	30	30
25m BHU	25	95.3	71.5	38	41

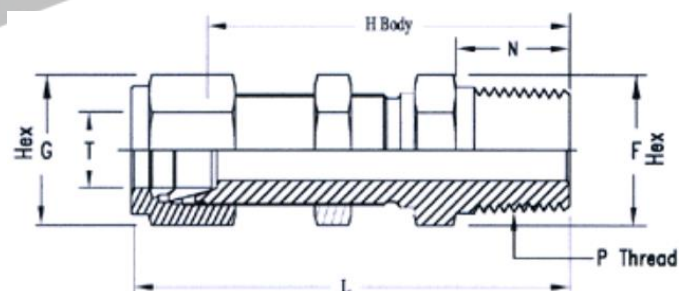

Imperial Range		Dimensions are in inches			
Part No.	T OD	L	H BODY L	G NUT	F BODY
6 BHU	1/4	2.27	1.9	9/16	5/8
8 BHU	3/8	2.46	1.88	11/16	3/4
10 BHU	1/2	2.80	2.00	7/8	15/16
12 BHU	5/8	2.87	2.06	1.01	1.01
20 BHU	3/4	3.11	2.31	1 1/8	1 3/16
25 BHU	1	2.81	2.81	1 1/2	1 5/8

• Bulkhead Female Connector

Metric Range		Dimensions are in mm			
Part No.	T OD	L	H BODY L	G NUT	F BODY
6m TTT	6	54.4	39.6	14	15
8m TTT	8	59.4	44.4	16	15
10m TTT	10	61.6	46.2	19	17
12m TTT	12	70.0	51.0	22	22
20m TTT	20	78.8	58.8	30	27
25m TTT	25	90.5	67.1	38	36

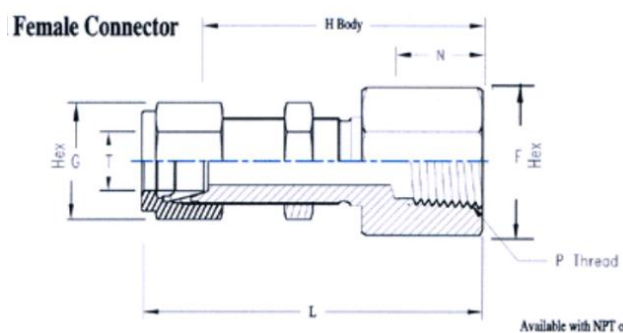

Imperial Range		Dimensions are in inches			
Part No.	T OD	L	H BODY L	G NUT	F BODY
6 TTT	1/4	2.25	1.56	9/16	0.6
8 TTT	3/8	2.40	1.82	11/16	0.6
10 TTT	1/2	2.76	1.96	7/8	7/8
12 TTT	5/8	2.92	2.12	1.0	15/16
20 TTT	3/4	3.02	2.22	1 1/8	1.06
25 TTT	1	3.58	2.62	1 1/2	1 3/8

• Male Branch Tees

Metric Range			Dimensions are in mm					
Part No.	T OD	A	P	N	L	H BODY L	G NACK	F BODY
6mMBT4	6	23.8	1/4'	14	54.4	39.6	14	15
8 mMBT6	8	25.4	3/8"	14	44.4	44.4	16	19
10 mMBT8	10	32.0	1/2'	19	49.8	49.8	19	22
12 mMBT8	12	32.0	1/2'	19	49.2	49.2	22	22
16 mMBT8	16	35.0	1/2'	19	52.4	52.4	27	24
20 mMBT12	20	38.1	3/4"	19	65.0	65.0	30	30
25 mMBT16	25	46.8	1"	23.8	66.6	66.6	38	36

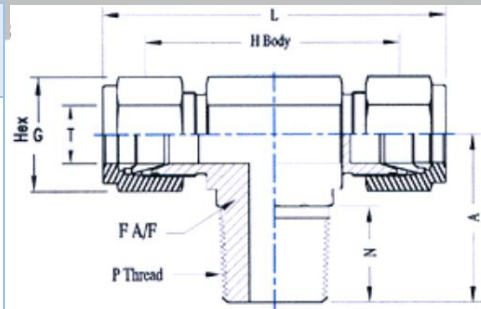

Imperial Range			Dimensions are in inches					
Part No.	T OD	A	P	N	L	H BODY L	G NACK	F BODY
6MBT4	1/4	0.94	1/4	0.56	2.14	1.56	9/16	0.6
8MBT6	3/8	1.00	3/8	0.56	2.42	1.82	11/16	0.75
10MBT8	1/2	1.08	1/4	0.56	2.76	1.96	7/8	7/8
12MBT8	1/2	1.26	1/2	0.75	2.76	1.96	7/8	7/8
16MBT8	5/8	1.38	1/2	0.75	2.92	2.12	1.0	1.0
20MBT12	3/4	1.50	3/4	0.75	3.13	2.32	1 1/8	1 1/16
25MBT16	1	1.85	1	0.95	3.56	2.63	1.5	1.38

• Male Run Tees

Metric Range			Dimensions are in mm					
Part No.	T OD	A	P	N	L	H BODY L	G NACK	F BODY
6mMRT4	6	27.2	1/4'	14	51.0	43.6	14	15
8 mMRT4	8	29.9	1/4"	14	55.3	46.0	16	15
10 mMRT6	10	34.4	3/8"	14	59.6	49.3	19	19
12 mMRT6	12	35.0	3/8"	14	68.3	57.9	22	22
12 mMRT8	12	36.3	1/2"	19	69.3	59.5	22	22
20 mMRT12	20	42.8	3/4"	19	80.8	70.5	30	27
25 mMRT16	25	45.2	1"	24	92.0	80.1	38	36

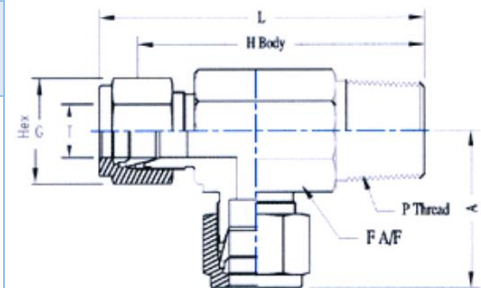

Imperial Range			Dimensions are in inches					
Part No.	T OD	A	P	N	L	H BODY L	G NACK	F BODY
6MRT4	1/4	1.09	1/4	0.56	2.03	1.71	9/16	0.6
8MRT4	3/8	1.23	3/8	0.56	2.35	2.05	11/16	3/4
10MRT6	1/2	1.38	1/2	0.56	2.50	2.09	7/8	7/8
12MRT6	1/2	1.44	1/2	0.75	2.75	2.34	7/8	7/8
12MRT8	5/8	1.44	1/2	0.75	2.75	2.34	1	1
20MRT12	3/4	1.56	3/4	0.75	3.06	2.65	1.18	1 1/16
25MRT16	1	1.78	1	0.94	3.15	3.15	1 1/2	1 3/8

• Ferrules

Metric Range		Dimensions are in mm	
Front Ferrule Part No.	T OD	Back Ferrule Part No.	
6m BF	6	6m FF	
8m BF	8	8m FF	
10m BF	10	10m FF	
12m BF	12	12m FF	
16m BF	16	16m FF	
18m BF	18	18m FF	
20m BF	20	20m FF	
25m BF	25	25m FF	

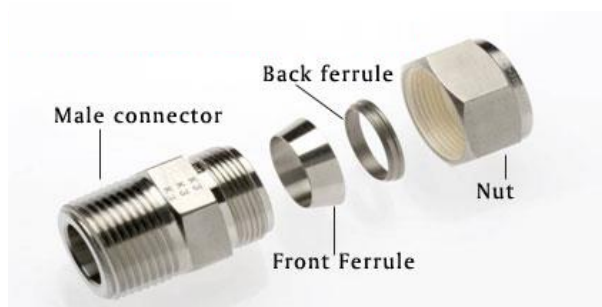
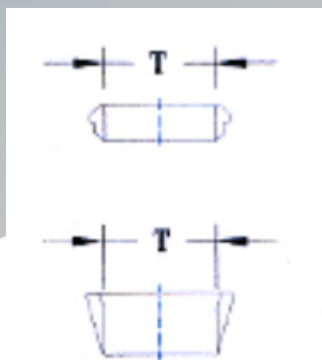

Imperial Range		Dimensions are in inches	
Front Ferrule Part No.	T OD	Back Ferrule Part No.	
2 BF	1/8	2 FF	
4 BF	1/4	4 FF	
5 BF	5/16	5 FF	
6 BF	3/8	6 FF	
8 BF	1/2	8 FF	
10 BF	5/8	10 FF	
12 BF	3/4	12 FF	
16 BF	1	16 FF	

• Nuts

Metric Range		Dimensions are in mm		
Part No.	T OD	L	G Nut	
6m N	6	13	14	
8m N	8	13.5	16	
10m N	10	14.3	19	
12m N	12	17.5	22	
16m N	16	17.5	27	
18m N	18	17.5	30	
20m N	20	17.5	30	
25m N	25	20.7	30	

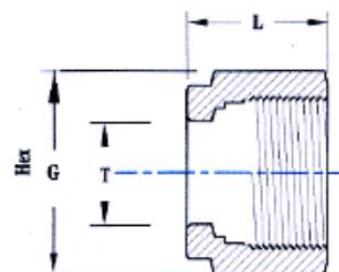

Imperial Range		Dimensions are in inches		
Part No.	T OD	L	G Nut	
2N	1/8	0.47	7/16	
4N	1/4	0.50	9/16	
5N	5/16	0.53	5/8	
6N	3/8	0.53	11/16	
8N	1/2	0.69	7/8	
10N	5/8	0.69	1	
12N	3/4	0.69	1 1/8	
16N	1	0.81	1 1/2	

PIPE FITTINGS

INDEX

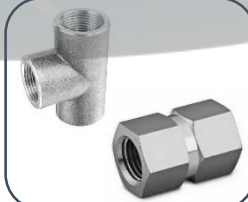

- **Female Tee/ Hex Coupling**
- Page 17



- **Female Elbow / Male Elbow**
- Page 18



- **Street Elbow / Adaptor**
- Page 19



- **Street Tee / Branch Tee**
- Page 20



- **Male Tee / Female Cross**
- Page 21



- **Pipe Plug / Hex Nipple**
- Page 22



- **Union 3 Pc / Pipe Cap**
- Page 23

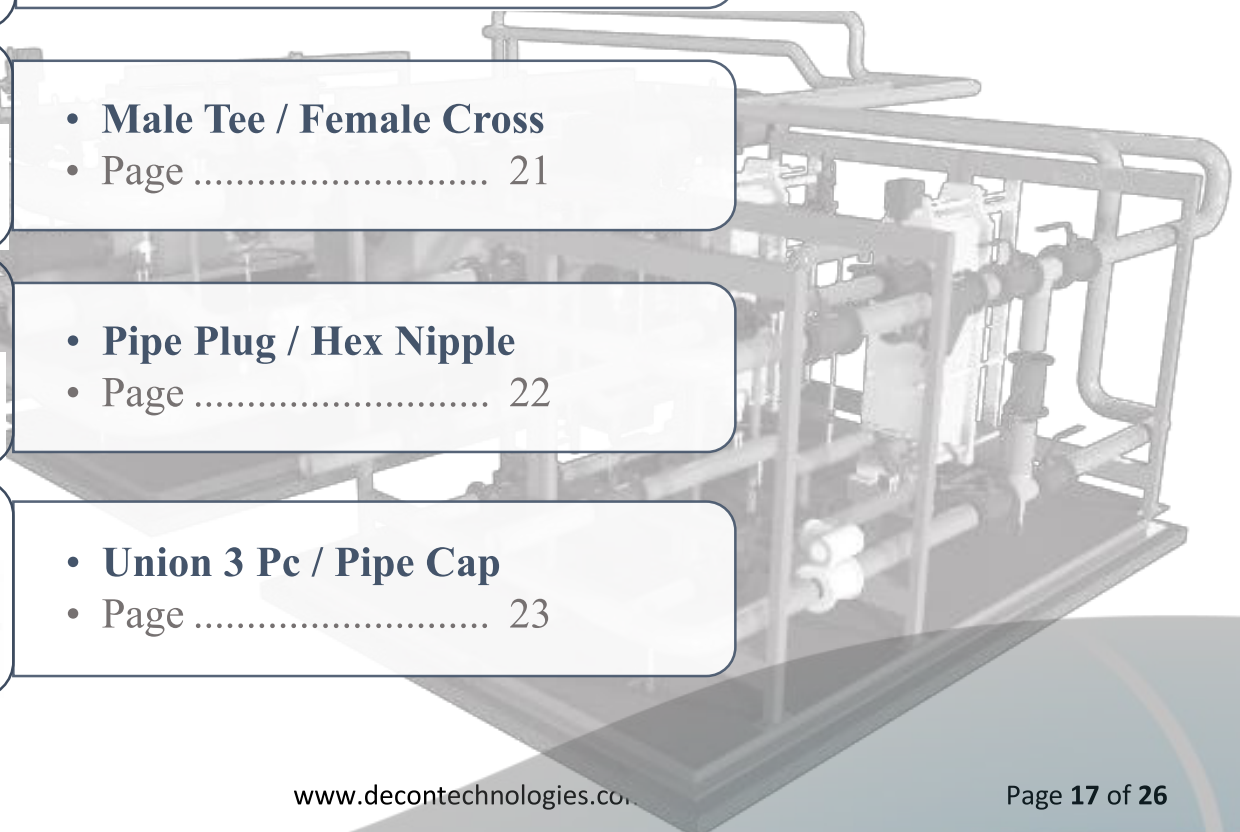

• Female Tee

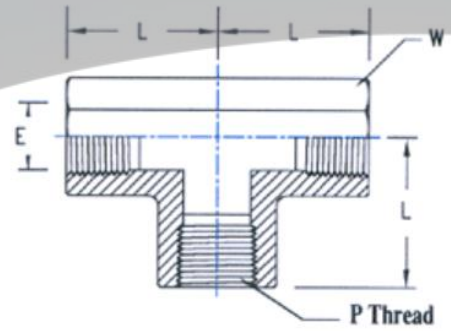

Part No.	P Female NPT Size	L	E Min. Opening	W Wrench Flate
		mm	mm	Mm
2-FFF T	1/8"	26.5	7.5	15.0
4-FFF T	1/4"	29.5	10.5	19.0
6-FFF T	3/8"	36.0	14.5	22.0
8-FFF T	1/2"	39.5	16.5	27.0
12-FFF T	3/4"	48.5	22.0	32.0
16-FFF T	1"	48.5	28.0	41.0



• Hex Coupling

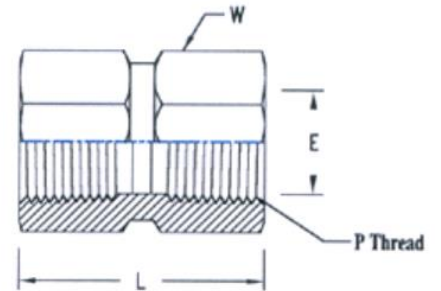

Part No.	P Female NPT Size	L	E Min. Opening	W Wrench Flate
		mm	mm	mm
2-FFF T	1/8"	26.5	7.5	15.0
4-FFF T	1/4"	29.5	10.5	19.0
6-FFF T	3/8"	36.0	14.5	22.0
8-FFF T	1/2"	39.5	16.5	27.0
12-FFF T	3/4"	48.5	22.0	32.0
16-FFF T	1"	48.5	28.0	41.0



Pipe fittings

• Female Elbow

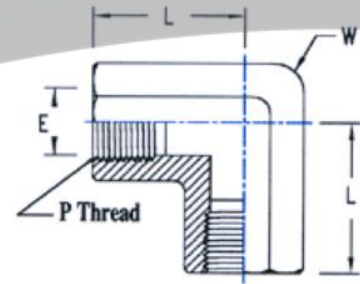

Part No.	P Female NPT Size	L	E Min. Opening	W Wrench Flate
		mm	mm	mm
2-FF E	1/8"	26.4	7.5	15.0
4-FF E	1/4"	29.7	10.5	19.0
6-FF E	3/8"	36.1	14.0	22.0
8-FF E	1/2"	39.6	16.5	27.0
12-FF E	3/4"	48.8	22.0	32.0
16-FF E	1"	48.5	28.0	41.0



• Male Elbow

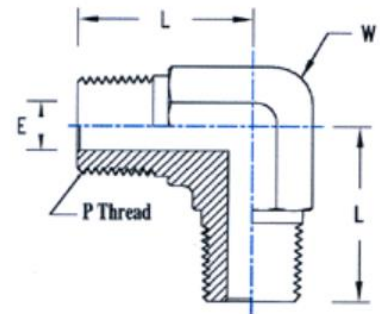

Part No.	P Male NPT Size	L	E Min. Opening	W Wrench Flate
		mm	mm	mm
2-MM E	1/8"	22.4	4.0	15.0
4- MM E	1/4"	26.7	7.1	15.0
6- MM E	3/8"	29.7	9.5	19.0
8- MM E	1/2"	36.8	11.8	22.0
12- MM E	3/4"	38.8	15.6	27.0
16- MM E	1"	45.2	22.0	35.0



• Street Elbow

Part No.	P Female NPT Size	P1 Male NPT Size	L	L1	E	W
			mm	mm	mm	mm
4-SE 4	1/4"	1/4"	29.8	29.8	4.8	19.0
6-SE 4	3/8"	1/4"	36.1	32.0	7.0	22.0
6-SE 6	3/8"	3/8"	36.1	32.0	9.5	22.0
8-SE 4	1/2"	1/4"	39.5	35.0	7.1	27.0
8-SE 8	1/2"	1/2"	39.6	39.6	11.8	27.0
12-SE 12	3/4"	3/4"	48.8	42.4	15.0	32.0

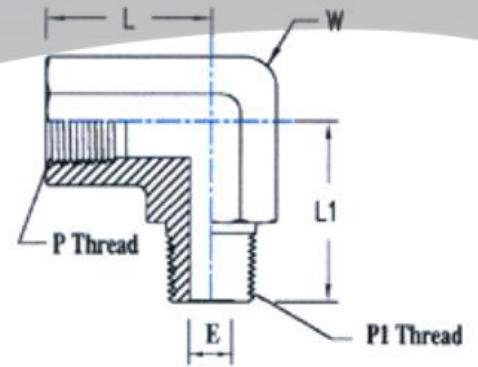

• Adapter

Part No.	P Female NPT Size	P1 Male NPT Size	L	E	W
			mm	mm	mm
2-AMF	1/8"	1/8"	27.9	4.8	14.0
4-AMF	1/4"	1/4"	35.6	7.0	19.0
6-AMF	3/8"	3/8"	38.4	9.5	22.0
8-AMF	1/2"	1/2"	48.0	11.8	27.0
12-AMF	3/4"	3/4"	50.8	15.0	32.0
18-AMF	1"	1"	57.0	22.0	41.0

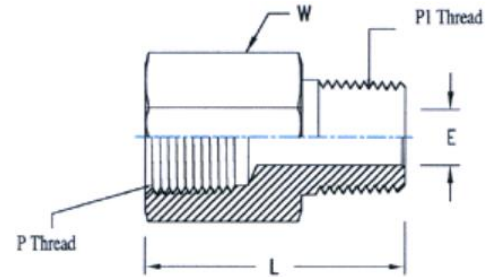

• Street Tee

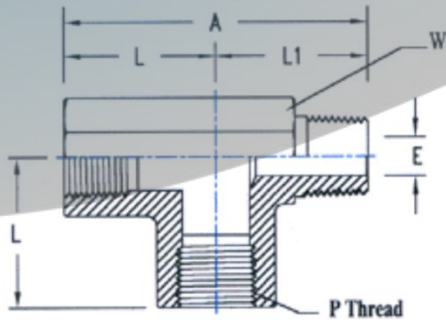

Part No.	P Male & Female NPT Size	A	L	L1	E	W
		mm	mm	mm	Min. Opening mm	Wrench Flat mm
2-ST	1/8"	48.5	26.4	22.1	4.5	15.0
4-S	1/4"	59.4	29.7	29.7	7.0	19.0
6-ST	3/8"	68.1	36.1	32.0	9.5	22.0
8-ST	1/2"	79.2	39.6	39.6	11.8	27.0
12-ST	3/4"	97.5	48.7	49.0	15.0	32.0
16-ST	1"	97.0	48.5	49.0	22.0	41.0

• Branch Tee

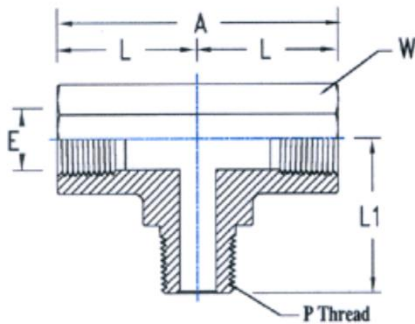

Part No.	P Male & Female NPT Size	A	L	L1	E	W
		mm	mm	mm	Min. Opening mm	Wrench Flat mm
2-BT	1/8"	52.8	26.4	22.1	4.5	15.0
4-BT	1/4"	59.4	29.7	29.7	7.0	19.0
6-BT	3/8"	68.1	34.1	32.0	9.5	22.0
8-BT	1/2"	79.2	39.6	39.6	11.8	27.0
12-BT	3/4"	97.2	48.7	49.0	15.0	32.0
16-BT	1"	97.0	48.5	49.0	22.0	41.0

• Male Tee

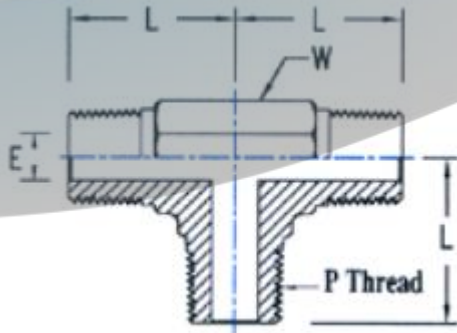

Part No.	P Male NPT Size	L	E Min. Opening	W Wrench Flat
		mm	mm	mm
2-MMM T	1/8"	22.4	4.8	11.0
4-MMM T	1/4"	26.7	7.1	16.0
6-MMM T	3/8"	29.7	9.6	19.0
8-MMM T	1/2"	36.8	11.9	22.0
12-MMM T	3/4"	38.0	15.8	27.0
16-MMM T	1"	47.6	22.0	35.0

• Female Cross

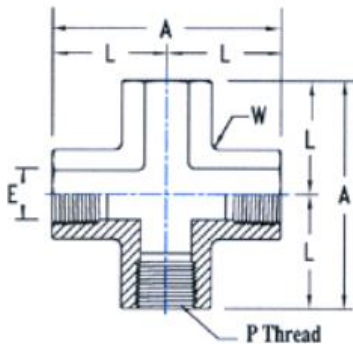

Part No.	P Male NPT Size	L	E Min. Opening	W Wrench Flat
		mm	mm	mm
2-CR F	1/8"	26.4	7.5	16.0
4-CR F	1/4"	29.7	10.5	19.0
6-CR F	3/8"	36.1	14.0	22.0
8-CR F	1/2"	39.6	16.5	27.0
12-CR F	3/4"	48.8	22.0	32.0
16-CR F	1"	48.5	28.0	41.0

• Pipe Plug

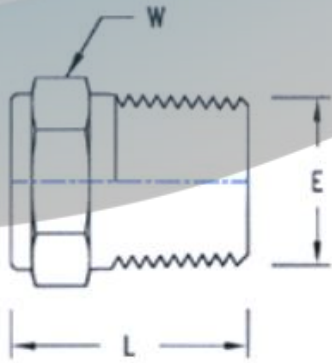

Part No.	P Male NPT Size	L	W Hex.
		mm	mm
2-PP	1/8"	16.0	11.0
4-PP	1/4"	20.0	14.0
6-PP	3/8"	21.0	17.2
8-PP	1/2"	28.0	22.0
12-PP	3/4"	29.0	27.0
16-PP	1"	36.0	36.0

• Hex Nipple

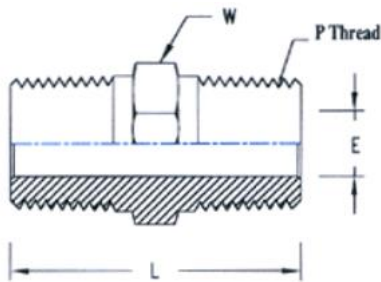

Part No.	P Male NPT Size	L	E Min. Opening	W Hex.
		mm	mm	mm
2-HN	1/8"	26.0	4.8	11.0
4-HN	1/4"	35.6	7.0	14.0
6-HN	3/8"	36.0	9.5	17.2
8-HN	1/2"	46.7	11.8	22.0
12-HN	3/4"	46.7	15.0	27.0
16-HN	1"	58.5	22.0	36.0

• Union 3 Pc

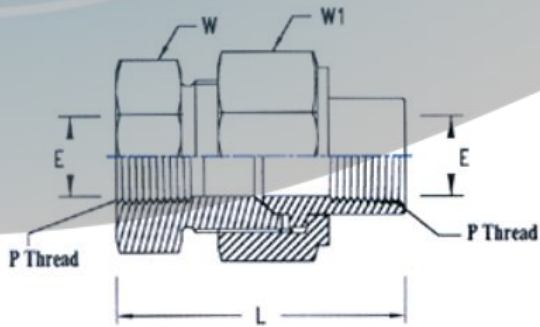

Part No.	P Female NPT Size	L	E	W	W1
		mm	Min. Opening mm	Wrench Flate mm	Wrench Flate mm
2-U Pc	1/8"	46.0	6.5	24.0	28.5
4-U Pc	1/4"	59.0	9.0	30.0	36.0
6-U Pc	3/8"	63.0	12.0	36.0	38.0
8-U Pc	1/2"	68.0	15.0	41.0	46.0
12-U Pc	3/4"	78.0	20.0	46.0	50.0
16-U Pc	1"	90.0	25.0	60.0	63.0

• Pipe Cap

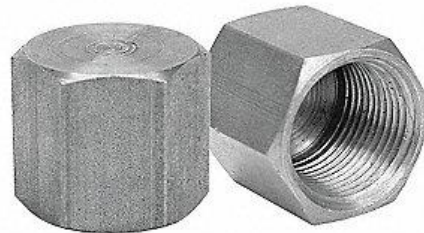
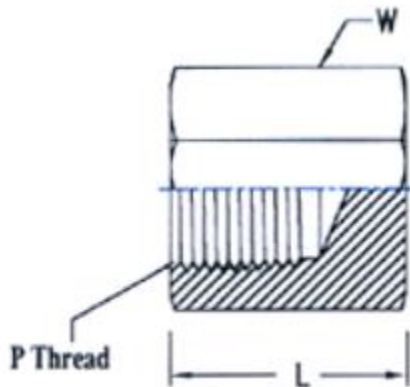

Part No.	P Female NPT Size	L	W
		mm	Wrench Flate mm
2-PC	1/8"	19.0	14.0
4-PC	1/4"	23.0	19.0
6-PC	3/8"	26.0	22.0
8-PC	1/2"	32.0	27.0
12-PC	3/4"	34.0	32.0
16-PC	1"	40.0	41.0



WE *CONNECT THE WORLD*



 : sales@deconconnect.com

 : +65 9782 1432